

8-2 콘트롤 릴레이 Control Relay

■ **YONG SUNG** File No. E200434

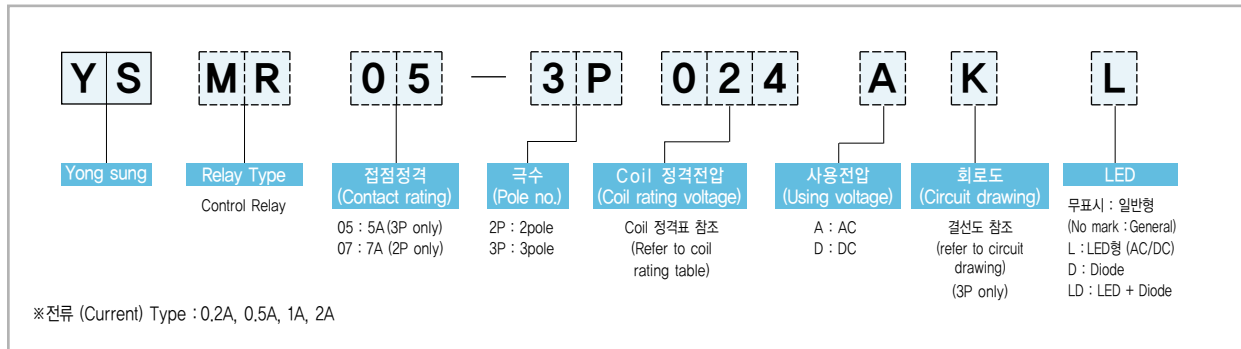

형식 구분도 | Type Classification Diagram



특징 | Features

- 외형은 소형이면서도 7A의 부하를 개폐할 수 있어 일반제어회로에 널리 사용할 수 있습니다.
- 적용전압(코일전압)의 선택의 폭이 넓어 회로구성이 용이합니다.
- 교환이 용이합니다.
- 기계적 수명이 500만회 이상으로 오래도록 사용할 수 있습니다.
- As even with mini type can switch 7A load, it can be widely used for general control circuit.
- Easy to compose circuit due to wide range of rating voltage.
- Easy replacement.
- With above 5 million times of mechanical lifetime, it can be long used.

성능 개요 | Performance Summary

접촉저항 (Contact resistance)		below 50mΩ (Initial value)
절연저항 (Insulation resistance)		above 100MΩ (DC 500V.Meg)
내전압 (Withstand voltage)		AC 2,000V/min / AC 1,000V/min (접점간) Between contacts
수명 (Lifetime)	기계적 (Mechanical)	above 5,000,000times
	전기적 (Electrical)	above 500,000times
동작시간 (Operating time)		AC below 20ms DC below 30ms
복귀시간 (Return time)		below 20ms
내진동 (Withstand vibration)	오동작 (Malfunction)	10~55Hz double amplitude 1.0mm
	내구 (Endurance)	10~55Hz double amplitude 1.5mm
내충격 (Withstand impact)	오동작 (Malfunction)	100m/S ² (about 10G)
	내구 (Endurance)	500m/S ² (about 50G)
최대개폐빈도 (Max. Switching frequency)	기계적 (Mechanical)	20 times/min
	전기적 (Electrical)	20 times/min
사용주위온도 (Ambient temperature)		-25℃ ~ +40℃
상대습도 (Relative humidity)		45 ~ 85%

릴레이

코일 정격 | Coil Rating |

	정격전압(V) (Rating voltage)	정격전류(mA) (Rating current)	COIL 저항(Ω) (Coil resistance)	소비전력(VA,W) (Power Consumption)	최대연속인가전압 (Max. continuous applied voltage)	최소동작전압 (Min. operational Voltage)	복귀전압 (Return Voltage)
AC	24	88	100	2.3VA	110%	below 80%	above 30%
	110	21	2,000	2.2VA			
	220	11	8,120	2.3VA			
DC	24	85	280	2.0W	110%	below 80%	above 10%
	48	36	1,330	1.8W			
	110	14	8,150	1.6W			
	125	11	11,420	1.4W			
	220	8.8	23,210	2.0W			

- ※주 1. 정격전류의 허용범위 (23°C일때) : (mA)±15%
2. Coil 저항의 허용범위 (23°C일때) : (Ω)±10%

- ※Note 1. Allowable range of rating current (at 23°C) : (mA)±15%
2. Allowable range of coil resistance (at 23°C) : (Ω)±10%

접점 정격 | Contact Rating |

구분 (Classification)	최대접점용량 (Max. Contact Capacity)					정격통전전류(A) (Rating conductive current)
	접점허용전력 (Contact Allowable Power)		전압(V) (Voltage)	정격부하 (Rating load)		
	저항부하 (Resistance load)	유도부하 (Inductive load)		저항부하 (Resistance load) (COSφ=1)	유도부하 (Inductive load) (COSφ=0.4, L/R=7ms)	
MR07	AC1540VA	AC660VA	AC220V	7	3	7
	DC120W	DC96W	DC24V	5	4	
MR05	AC1100VA	AC440VA	AC220V	5	2	5
	DC72W	DC60W	DC24V	3	2.5	

내부 구조도 | Inside Structure Diagram |

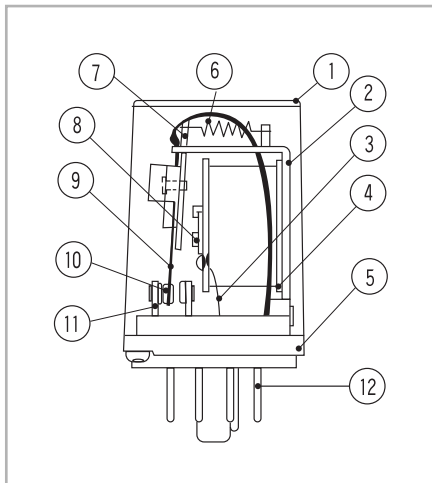

No.	부품명 (Part Names)	재질 (Materials)
1	Cover	수지 (Polycarbonate Resin)
2	Frame	탄소강 (Carbon Steel)
3	Coil	구리선 (Copper Wire)
4	Bobbin	66 나일론 (Nylon 66)
5	Plug	PBT Resin
6	복귀 Spring (Return Spring)	스테인리스 (Stainless Steel)
7	Amature	순철 (Pure Iron)
8	Shaft	순철 (Pure Iron)
9	유동단자 (Swing Terminal)	인천동 (Phosphor Bronze)
10	접 점 (Contact)	은접점 (Ag)
11	고정단자 (Fixed Terminal)	황동 (Brass)
12	리드단자 (Lead Terminal)	황동 (Brass)

외형 / 치수도

| Shape / Dimension Drawing |

(unit : mm)

YSMR07-2P



적용소켓 : YSSK 08
(Applied socket : YSSK 08)

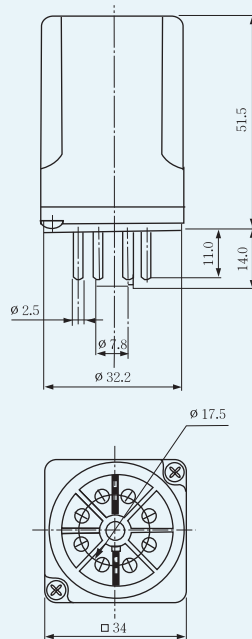

내부 결선도

| Inside Connection Diagram |

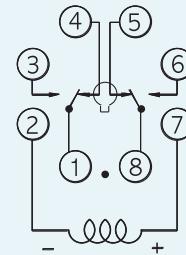

YSMR07-2P

YSMR05-3P



적용소켓 : YSSK 11
(Applied socket : YSSK 11)

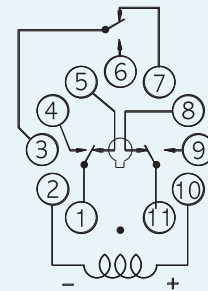
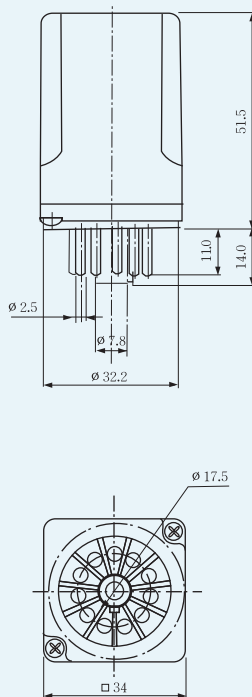

YSMR05-3P

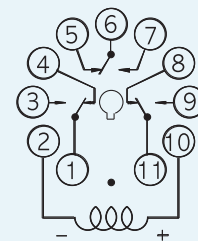

YSMR05-3P
(K Type)

*주문 Type (Ordered production)